

Propriétaire



**MAXIMUS**

Une entreprise d'Ingersoll Rand

Confidentialité et politiques

Ce document est la propriété de MAXIMUS et ne peut être utilisé pour d'autres fins que celles pour lesquelles il a été préparé et soumis. Aucune reproduction ne peut être faite sans autorisation.

The information contained in this drawing is the sole property of MAXIMUS. Any reproduction in part or as a whole without the written permission is prohibited.

@2019-2025 Tous les droits réservés / All rights reserved.

No. de produit / Product Part Number:

**6100-0031**

Designation du produit / Product Name

**KIT STATION METEO**

Titre du dessin / Drawing Title

**GUIDE D'INSTALLATION**

Révision / Revision Feuille / Sheet:

**00**

**1 / 1**

Matériau / Material specifications:

**S/O**

Unités / Units:

**mm[po]**

Tolérances Standard:

Pouces/Inches

X/X ± 1/16"  
X.XX" ± 0.03"  
X.XXX" ± 0.010"

Millimètres/Millimeters

X.X ± 0.8  
X.XX ± 0.25

Angle

X.X° ± 0.5°

Dernière mise à jour / Last update date:

**2025-08-13**

Dessiné par / Drawn by:

**SR**

Approuvé par / Approved by:

**LJ**

Historique de révisions / Revision history:

Historique de révisions / Revision history:

REV.	DESCRIPTION
00	RELÂCHE INITIALE - REMPLACE 105-00035

**INCLUS DANS LE KIT**

A

B

C

D

E

F

1

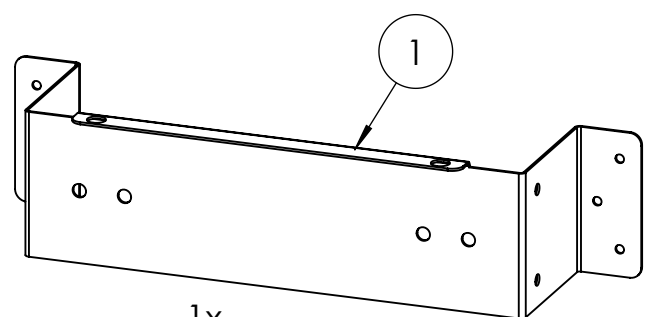

1x VSUP0501

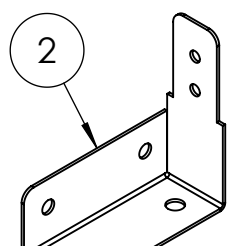

1x VSUP0505

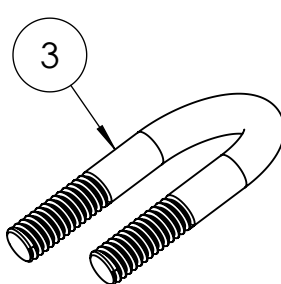

2x BBOS2517

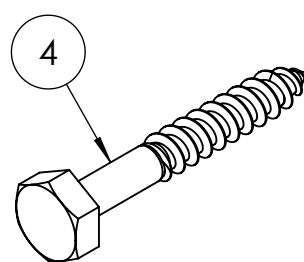

6x BOS45150

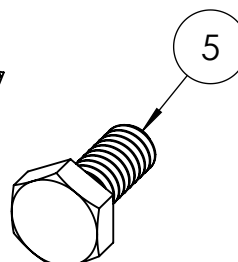

2x BOS04075

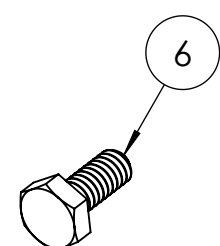

2x BOS01063

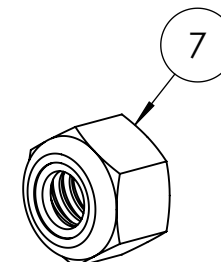

4x NUS10050

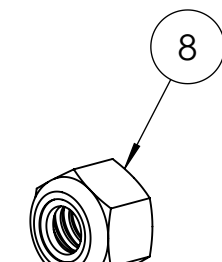

2x NUT10040

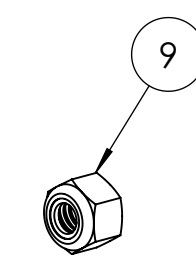

2x NUS10030

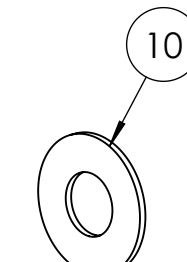

8x WAS00050

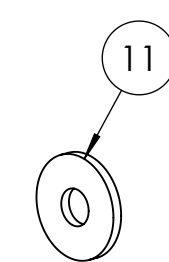

2x WAS00032

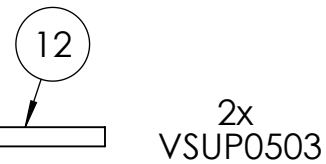

2x VSUP0503

2

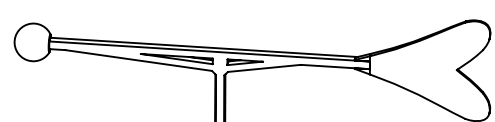

**OPTION 1  
(CAPTEUR À DROITE)**

3

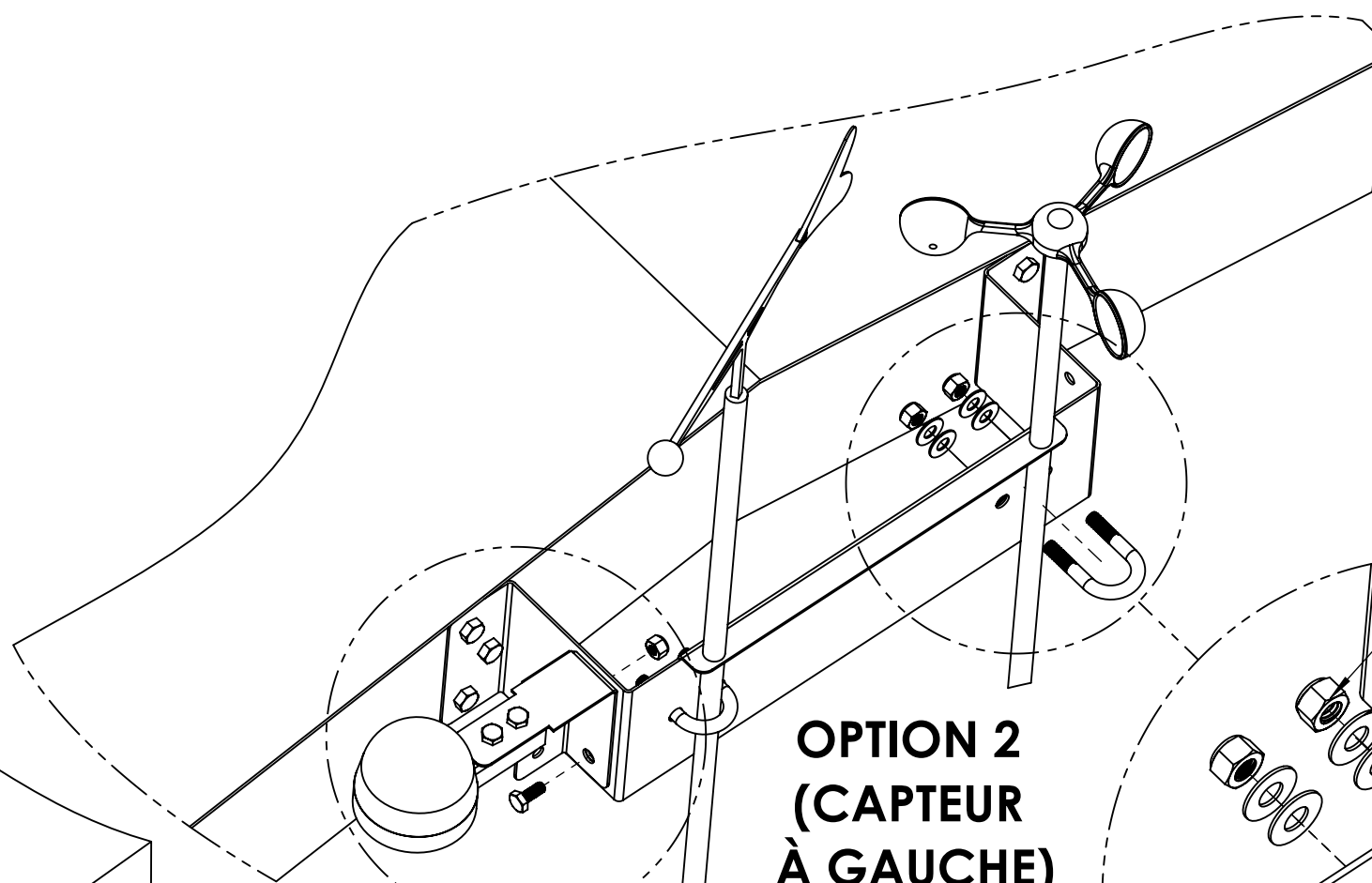

**OPTION 2  
(CAPTEUR À GAUCHE)**

4

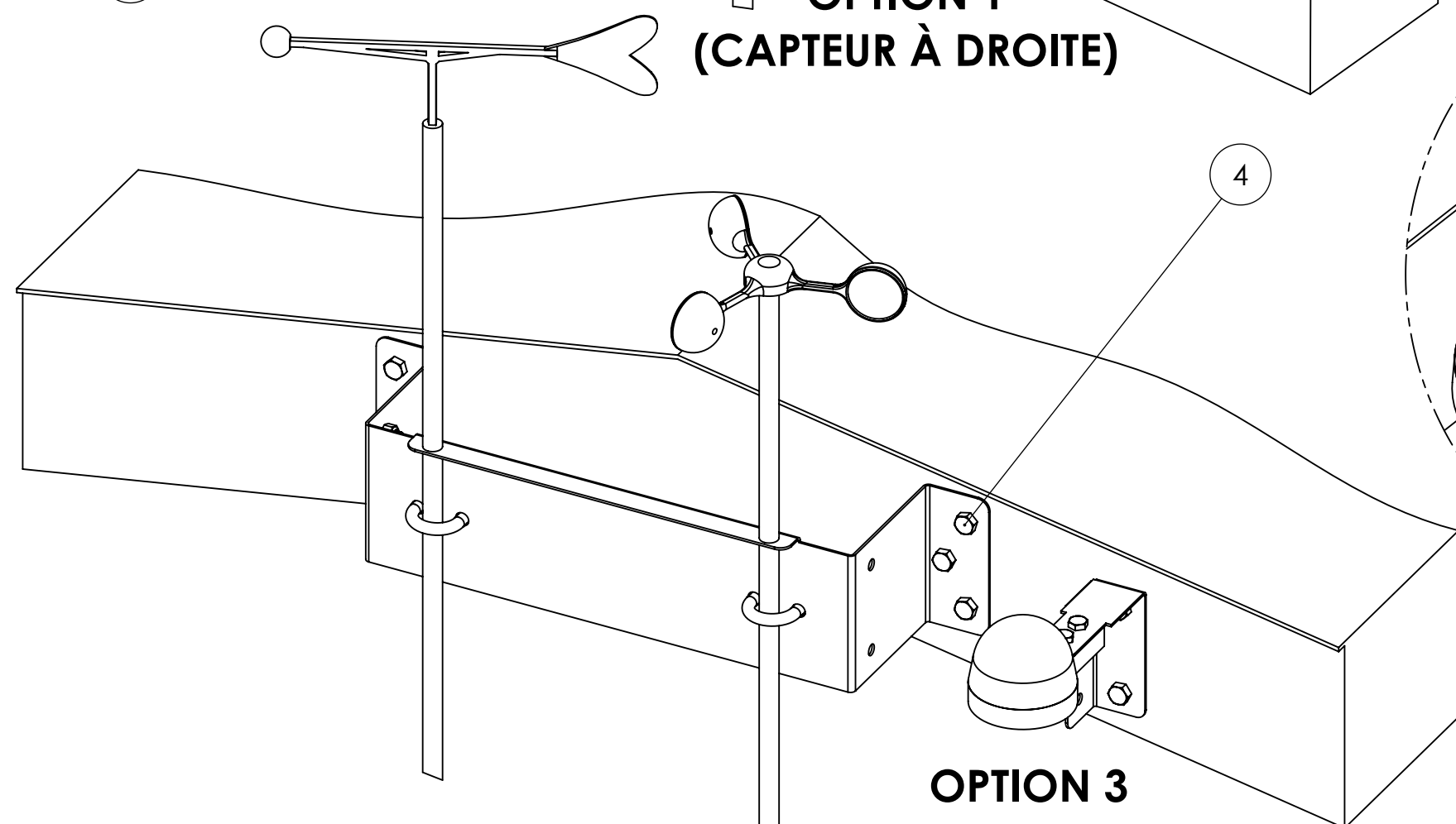

**OPTION 3  
(CAPTEUR SUR LE MUR -  
VOIR NOTES)**

5

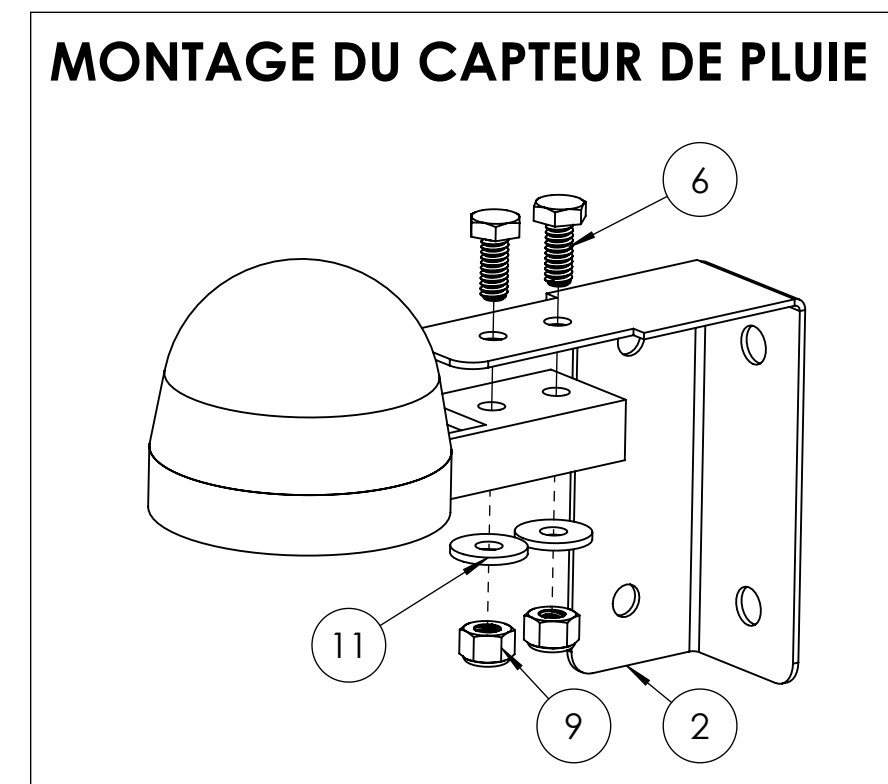

6

**NOTES :**

- VOIR LE GUIDE D'INSTALLATION MAXIMUS POUR LES BRANCHEMENTS DE L'ANÉMOMÈTRE, DE LA GIROUETTE ET DU CAPTEUR DE PLUIE.
- LE CÂBLE ENTRE LE CIRCUIT D'ALIMENTATION (PCB 104) ET LE CAPTEUR DE PLUIE NE DOIT PAS ÊTRE PLUS LONG QUE 9 m (30 PIEDS).
- SI LE CÂBLE EST PLUS LONG QUE 9 m (30 PIEDS), FAIRE L'INSTALLATION DU CAPTEUR SUR LE MUR DU BÂTIMENT (OPTION 3). LES VIS REQUISES NE SONT PAS INCLUSES DANS CE KIT.

Propriétaire



**MAXIMUS**

An Ingersoll Rand Business

Confidentialité et politiques

Ce document est la propriété de MAXIMUS et ne peut être utilisé pour d'autres fins que celles pour lesquelles il a été préparé et soumis. Aucune reproduction ne peut être faite sans autorisation.

The information contained in this drawing is the sole property of MAXIMUS. Any reproduction in part or as a whole without the written permission is prohibited.

@2019-2025 Tous les droits réservés / All rights reserved.

No. de produit / Product Part Number:

**6100-0031**

Designation du produit / Product Name

**WEATHER STATION KIT**

Titre du dessin / Drawing Title

**INSTALLATION GUIDE**

Révision / Revision Feuille / Sheet:

**00**

**1 / 1**

Matériau / Material specifications:

**N/A**

Unités / Units:

**mm[in]**

Tolérances Standard:

Pouces/Inches

X/X ± 1/16"  
X.XX" ± 0.03"  
X.XXX" ± 0.010"

Millimètres/Millimeters

X.X ± 0.8  
X.XX ± 0.25

Angle

X.X° ± 0.5°

Dernière mise à jour / Last update date:

**2025-08-13**

Dessiné par / Drawn by:

**SR**

Approuvé par / Approved by:

**LJ**

Historique de révisions / Revision history:

REV.	DESCRIPTION
00	INITIAL RELEASE - SUPERSEDE 105-00035

**INCLUDED IN THE KIT**

A

B

C

D

E

F

1

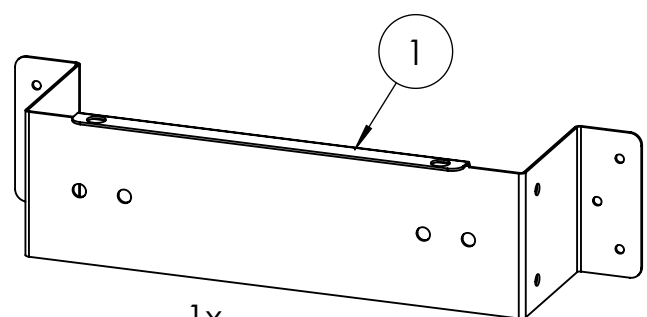

1x  
VSUP0501

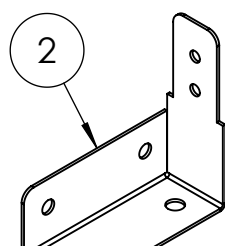

1x  
VSUP0505

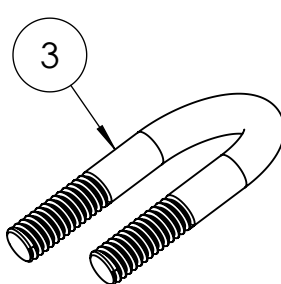

2x  
BBS2517

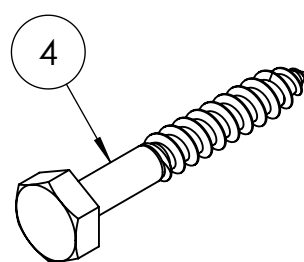

6x  
BOS45150

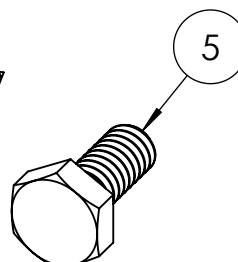

2x  
BOS04075

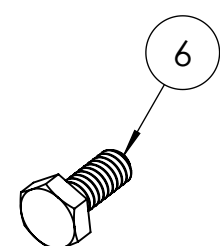

2x  
BOS01063

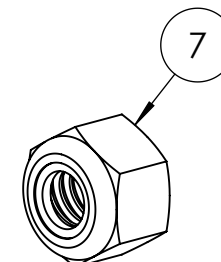

4x  
NUS10050

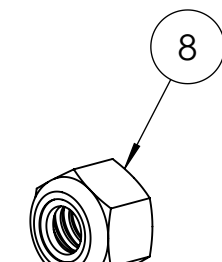

2x  
NUT10040

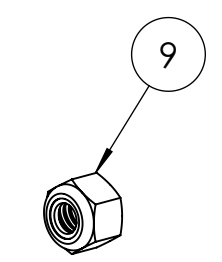

2x  
NUS10030

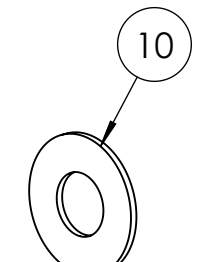

8x  
WAS00050

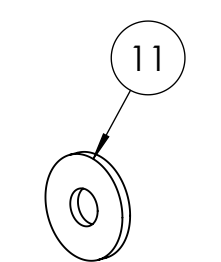

2x  
WAS00032

12

2x  
VSUP0503

2

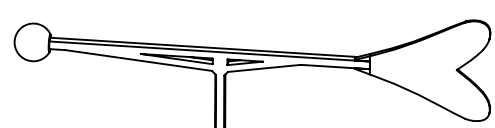

**OPTION 1  
(SENSOR TO THE RIGHT)**

3

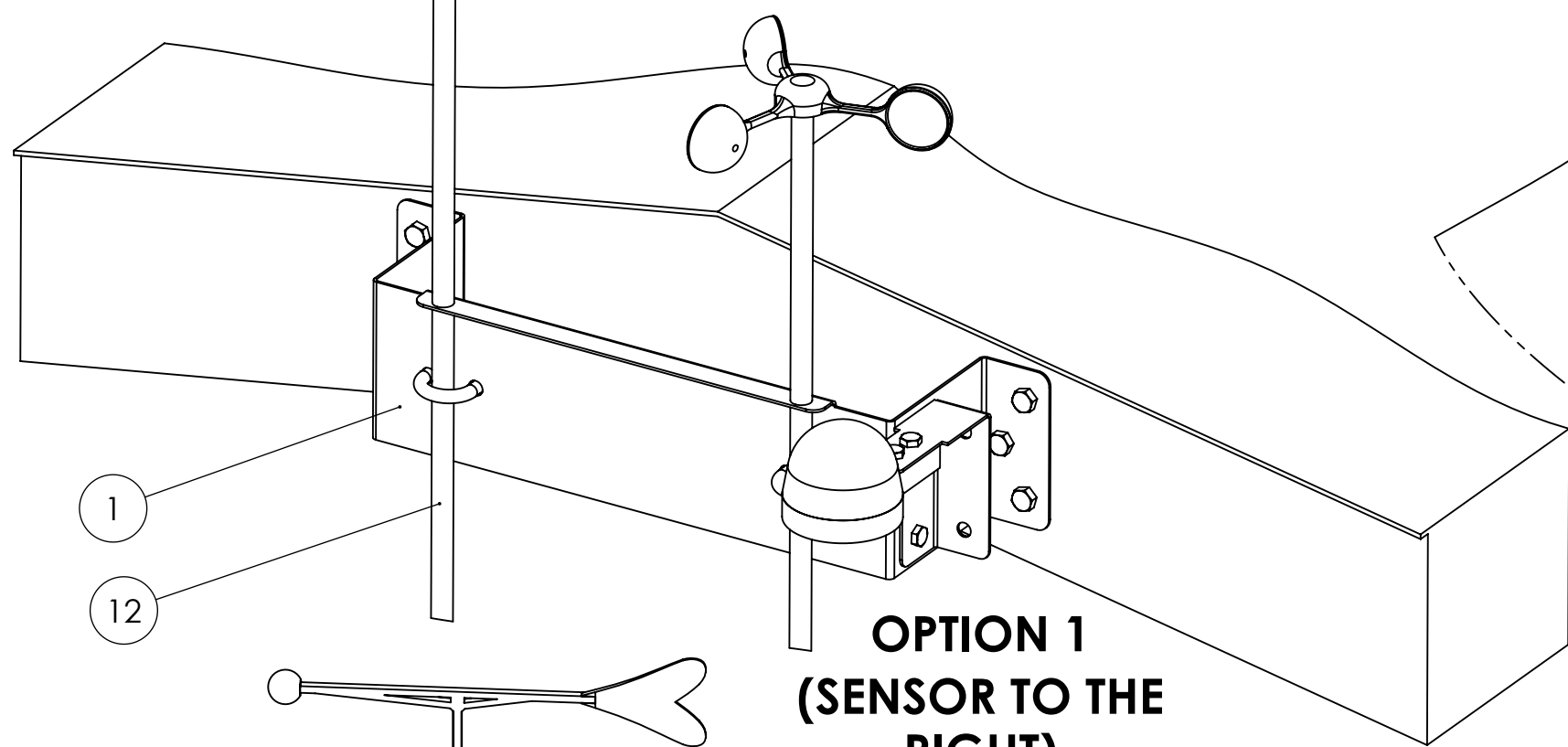

**OPTION 2  
(SENSOR TO THE LEFT)**

4

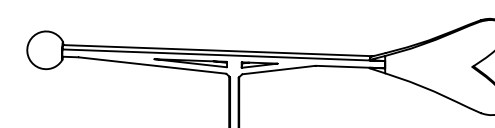

**OPTION 3  
(SENSOR ON THE WALL -  
SEE NOTES)**

5

6

- NOTES:**
- SEE THE MAXIMUS INSTALLATION GUIDE FOR THE ANEMOMETER, WEATHER VANE AND RAIN SENSOR CONNECTIONS.
  - THE LENGTH OF THE CABLE BETWEEN THE POWER SOURCE (PCB 104) AND THE RAIN SENSOR MUST NOT EXCEED 9 m (30 FEET).
  - IF THE CABLE IS LONGER THAN 9 m (30 FEET), INSTALL THE RAIN SENSOR ON THE BUILDING (OPTION 3). THE REQUIRED SCREWS ARE NOT INCLUDED IN THE KIT.

**RAIN SENSOR ASSEMBLY**

